

3

DOUBLED REAR WHEELS
(OPTIONAL)

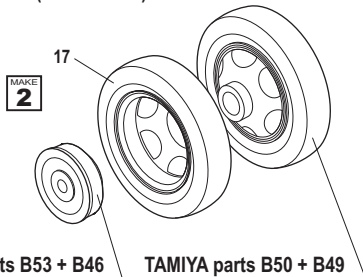

4

SPARE WHEEL FRONT MOUNTING
(OPTIONAL)

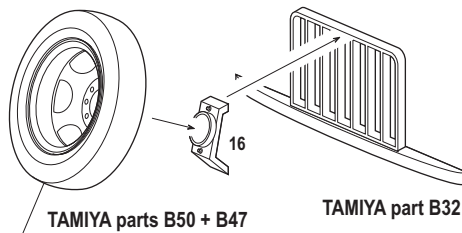

5

Painting

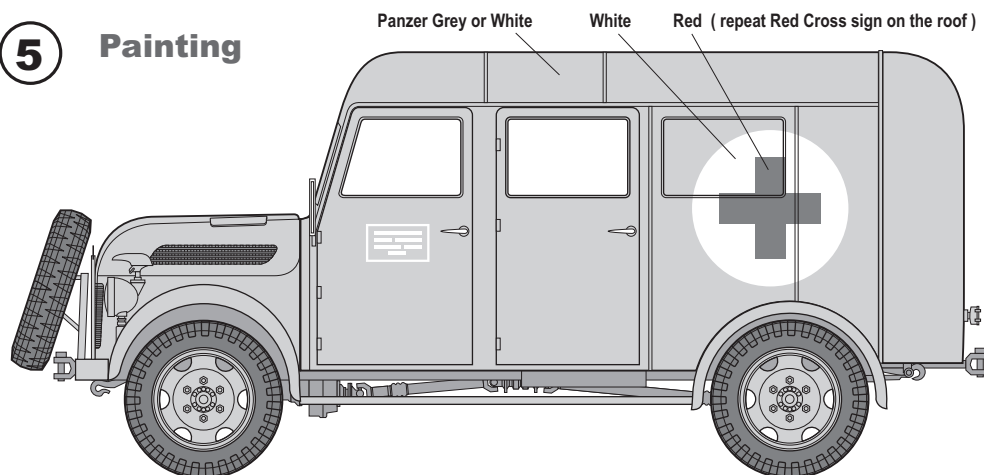

A. AMBULANCE

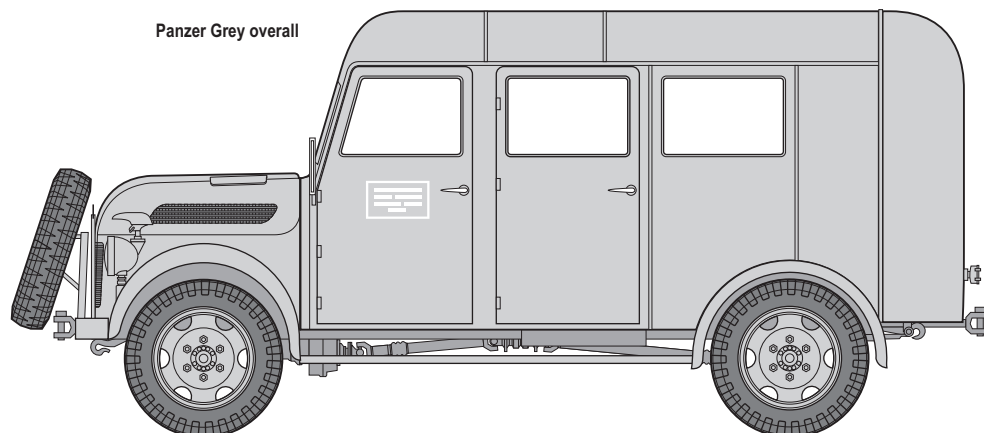

B. PERSONNEL OMNIBUS



LEADWARRIOR
HISTORICAL MINIATURE

WWW.LEADWARRIOR.COM
INFO@LEADWARRIOR.COM
Ebay: LEADWARRIOR

STEYR Type 1500A OMNIBUS

CONVERSION KIT for
TAMIYA Steyr Type 1500A (kit #35225)

26 RESIN PARTS



Austria's all wheel drive Steyr 1500A was one of the many personnel/transport vehicles which was designed to meet Whermacht requirement for standard army 1,5 ton truck. Built in 1941, the Steyr was used as troop transport in all the war theaters. A total of more than 20,000 were built, in a wide range of conversions.

Tamiya presents basic and command versions. Also Steyr 1500A chassis were used for Fire trucks, Omnibus, Ambulance or universal "Funk-Koffer" (Leadwarrior kit Lw35025), and different types of cargo and personnel carriers with opened, metal or wooden cabins. There were tests of trucks on railway drive.

This conversion kit presents quite rare Steyr 1500A conversion - general purpose Omnibus.

One of these vehicles is still preserved in Czech Republic. Most of experts consider that it was manufactured during war time by "Lohner Werke" in Veinna, though there are no any marking labels.

The configuration of the Omnibus is quite unusual - there are three main doors, with passenger door on the left side. 8-10 men could be transported, or, with the rear bench removed, in could be used as ambulance vehicle (in this case large trunk doors allow to load stretchers, etc.).

Preserved vehicle has the rear wheels doubled, but it could be post-war improvement. The spare wheel could be mounted in front of engine compartment.



*REMOVE

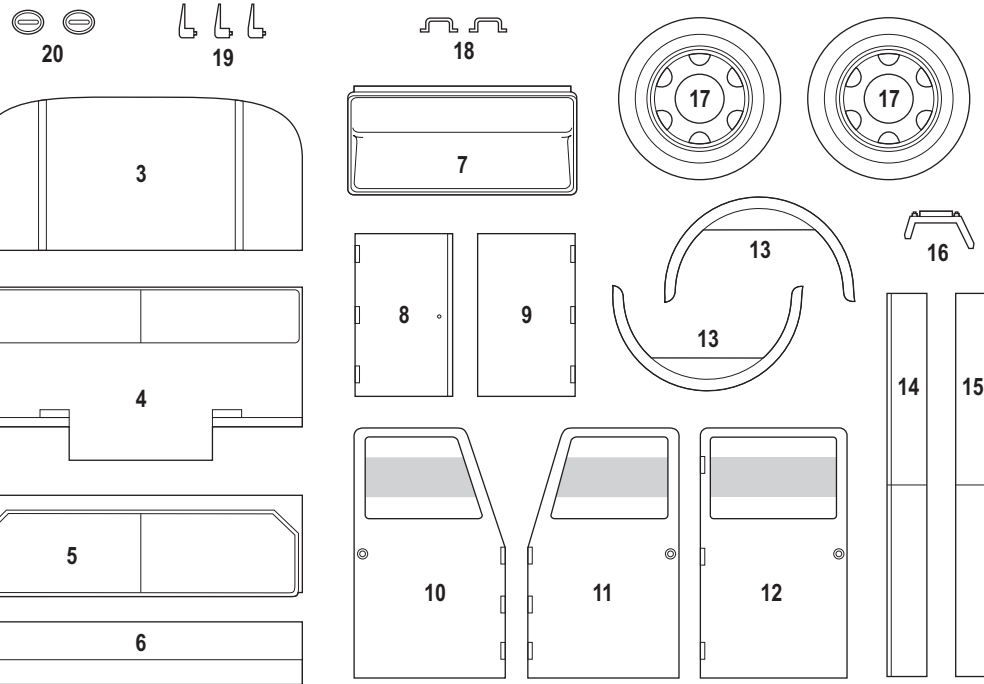
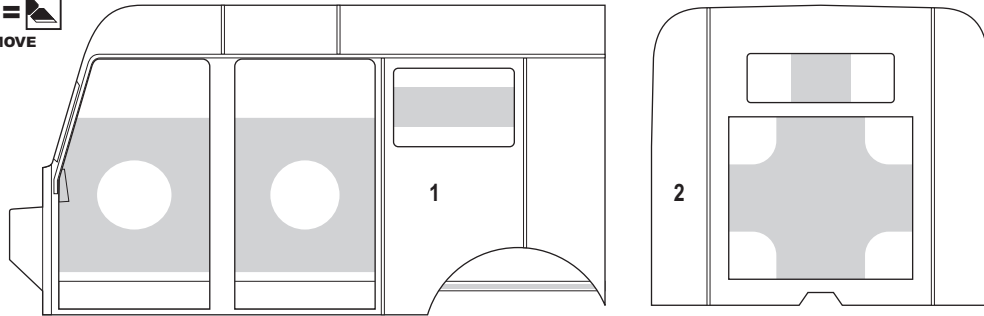

Cut / Remove part

Repeat on mirror side

Optional

Repeat several times

**STUDY THE INSTRUCTION CAREFULLY BEFORE ASSEMBLING.
TEST FIT PARTS TOGETHER BEFORE CEMENTING.
USE CYANOACRYLATE GLUE FOR RESIN PARTS.**

1 Interior assembling

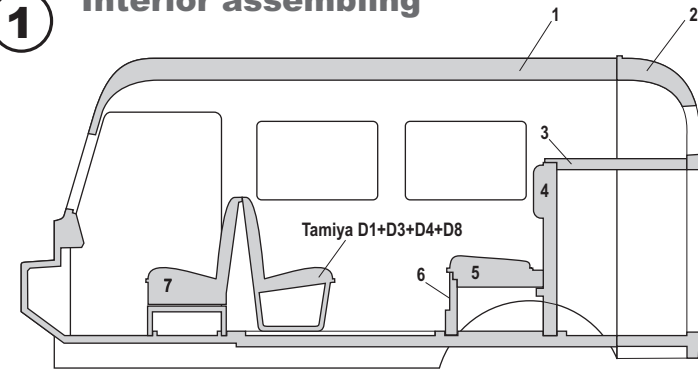

Install TAMIYA parts D10, B21, B26, B34, B37, and middle seat - parts D1, D3, D4

?
If assembled as Ambulance vehicle: Do not install resin parts 3, 4, 5, 6 (rear bench). Rear doors are for stretchers loading.

Crosssection views

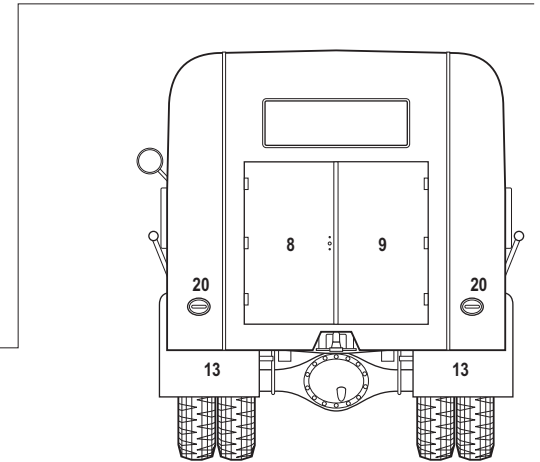
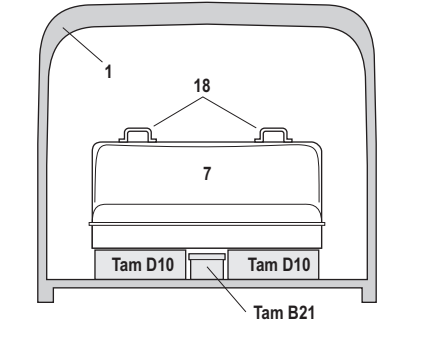

2 Exterior assembling

?
All the doors can be fixed opened or closed optionally

